

Package Contents

1. Open-Q™ 410 SOM with Qualcomm® APQ8016E SoC
2. Carrier board 13 x 13 cm
3. AC Power Adapter
4. HDMI cable
5. 13MP camera (optional) accessory
6. 4.5" FWVGA MIPI DSI LCD/Touch (optional accessory)

- | | | |
|---|---|--------------------------------------|
| 1. 12V DC Jack | 12. Boot settings | 22. Earpiece audio out |
| 2. Headset | 13. Volume down button | 23. 8GB eMMC/1GB LDDR3 RAM combo |
| 3. Line in | 14. Volume up button | 24. APQ8016E processor |
| 4. HDMI out on HDMI adaptor board (not shown) | 15. Power button | 25. WLAN/BT antenna connector (U.FL) |
| 5. USB client micro B | 16. Power and user defined LEDs | 26. GPS antenna connector (U.FL) |
| 6. 2 x USB host | 17. Camera module connector (CSI1) 2-lane | 27. WLAN WCN3620 and WGR7640 GPS * |
| 7. USB host switch | 18. Camera module connector (CSI0) 4-lane | 28. PM8916 power management IC |
| 8. Debug UART | 19. WLAN/BT antenna | * on bottom side |
| 9. UART LED | 20. Speaker out | |
| 10. Micro SD slot * | 21. Digital audio expansion connector * | |
| 11. Sensor and IoT expansion connector | | |

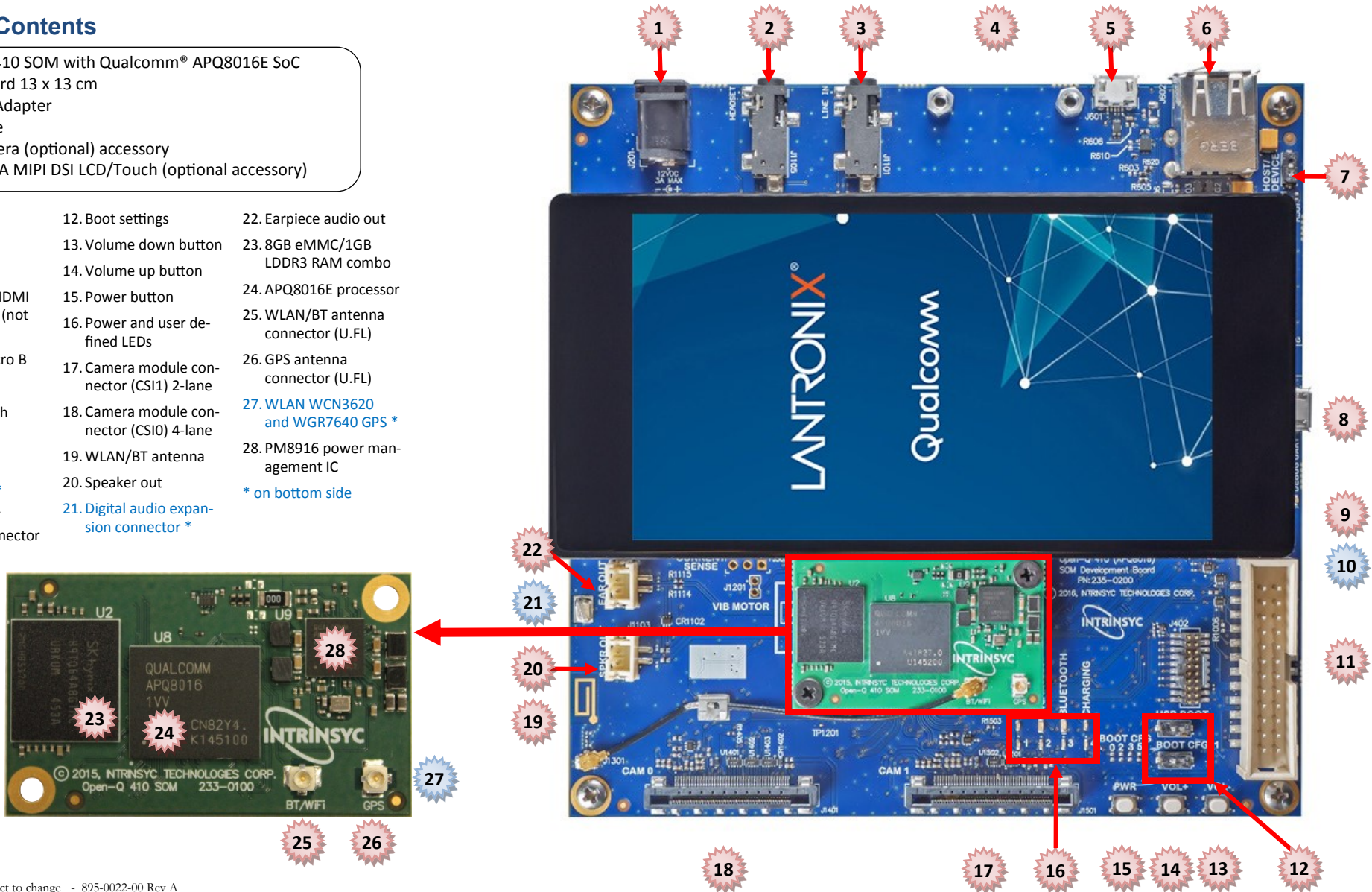

Specifications are subject to change - 895-0022-00 Rev A

Your use of this document is subject to and governed by those terms and conditions, <https://www.intrinsyc.com/legal-terms/qualcomm-terms.html>, in the Intrinsyc Purchase and Software License Agreement for the Open-Q™ 410 Development Kit based on the Qualcomm® APQ8016E SoC, which you or the legal entity you represent, as the case may be, accepted and agreed to when purchasing an Open-Q™ 410 Development Kit from Intrinsyc Technologies Corporation ("Agreement"). You may use this document, which shall be considered part of the defined term "Documentation" for purposes of the Agreement, solely in support of your permitted use of the Open-Q™ 410 Development Kit processor under the Agreement. Distribution of this document is strictly prohibited without the express written permission of Intrinsyc Technologies Corporation and its respective licensors, which they can withhold, condition or delay in its sole discretion.

Lantronix is a registered trademark of Lantronix, Inc. in the United States and other countries. Intrinsyc is a trademark of Intrinsyc Technologies Corporation, registered in Canada and other countries. Qualcomm is a trademark of Qualcomm Incorporated, registered in the United States and other countries. Other product and brand names used herein may be trademarks or registered trademarks of their respective owners. Qualcomm APQ8016E is a product of Qualcomm Technologies, Inc. and/or its subsidiaries.

Setup

1. Remove the development kit board carefully from the anti static bag
2. Connect the HDMI cable from the development kit to your display
3. Connect the Power Adapter; press the power button (PWR) for 5 seconds, the board will boot automatically
4. Documentation and software

To access the documentation (schematics, user guides, datasheets, programming guides, tech notes...), platform BSP software and much more, please register at: <http://tech.intrinsyc.com>

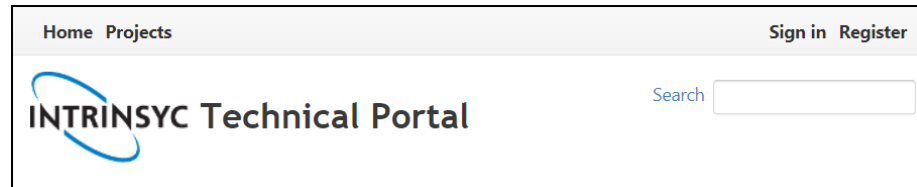

Support

For more information or assistance make sure to visit the Open-Q 410 FAQ page:

<http://www.intrinsyc.com/snapdragon-support/faq>

You can also contact us for technical support at:

<https://helpdesk.intrinsyc.com>

Should you require additional technical support for your Development Kit you can easily purchase a block of technical support hours from the Intrinsyc store:

<http://shop.intrinsyc.com/collections/technical-support-packages>

Thank you for purchasing the Open-Q 410 Development Kit